



SUBARU



EVOLTIS |





Disclaimer: The information and/or illustrations herein are for illustrative purposes only. Specifications of models may vary across markets and be dependent on local requirements and availability.

## Dream big. Live bigger.

Introducing the all-new Evoltis. It's the largest and most versatile Subaru ever, with three rows and seats for up to eight. Renowned Subaru quality, durability, and reliability give you the peace of mind you need as the Evoltis takes you to new heights on all your adventures.



## Ready to fit everyone.

Bring everyone and enjoy the versatile seating options and generous amounts of space inside. Available second-row captain's chairs make third-row access easy for anyone and seats up to seven, while the second-row bench offers seating for up to eight. The rich and roomy interior and latest entertainment features keep everyone comfortable and entertained on your journey.



### Spacious Second-row Seats

The available three-person bench seat provides comfort for all passengers so everyone can sit back and enjoy the ride.



### Rear-seat Climate Controls

Three separate climate control zones and vents in each row help customise the level of comfort no matter where you're sitting.





## The most versatile Subaru ever.

With many different seating configurations to choose from, the all-new Evoltis is ready for adventures of any size. The generous amount of cargo space fits just about anything while an under-floor storage area helps keep things organised. And with convenient features like the Power Rear Gate and easy-to-use roof rails, there's almost no task too big for the Evoltis.



Easy Third-row Access



Generous Cargo Space

Disclaimer: The information and/or illustrations herein are for illustrative purposes only. Specifications of models may vary across markets and be dependent on local requirements and availability.



## Subaru EyeSight Driver Assist Technology

**Like a second pair of eyes for the road ahead.**

Standard on every Evoltis, EyeSight Driver Assist Technology\*<sup>1</sup> comes with a wide range of innovative safety features that keeps an eye on the road, alerts you to potential danger, and even help you avoid a collision.

- 01 Pre-Collision Braking System\*<sup>2</sup>**  
Can warn you with a buzzer and flashing indicator when it senses an impending front collision, and even intervene to prevent the collision or reduce any impact.
- 02 Adaptive Cruise Control**  
Can look ahead and help automatically adjust your speed and distance from the vehicle ahead, a convenience in stop-and-go traffic.
- 03 Lane Departure and Sway Warning with Lane Keep Assist**  
Can help alert you with a buzzer and flashing indicator if it detects lane drift or lane departure without signaling and help keep you in your lane.
- 04 Pre-Collision Throttle Management**  
Can help alert you with a buzzer and flashing indicator when there is an object in front, and you put the gear in Drive instead of Reverse. Can cut engine power to prevent or minimise impact force.

\*<sup>1</sup> EyeSight is a driving support system which may not operate optimally under all driving conditions. The driver is always responsible for safe and attentive driving and observance of traffic regulations. System effectiveness depends on many factors such as vehicle maintenance, weather, and road conditions. See Owner's Manual for complete details on system operation and limitations for EyeSight including functions in this brochure.



\*<sup>2</sup> Pre-Collision Braking System may not work in all situations. Depending on the speed difference from objects, the object's height, and other conditions, every situation may not meet the necessary conditions for EyeSight to work optimally.



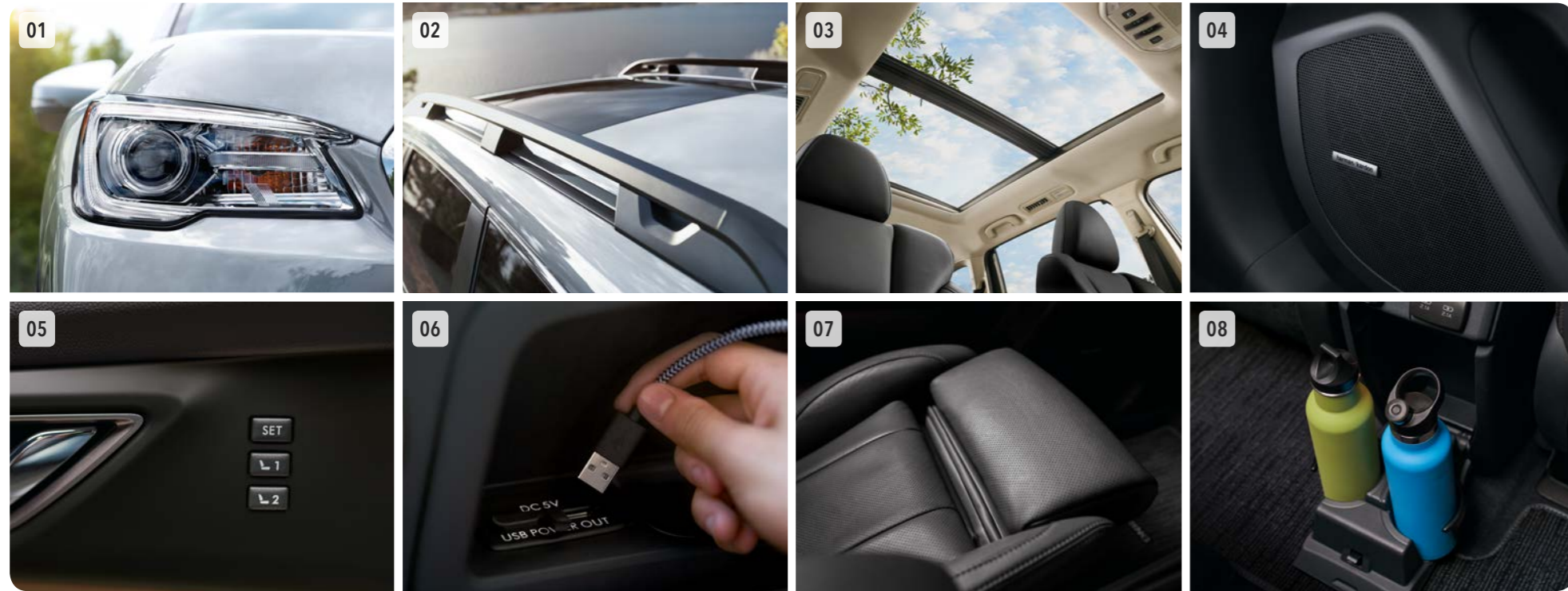

**01 LED Steering Responsive Headlights (SRH)**

These auto-leveling bifunctional LED headlamps combine low and high beams and are steering-responsive, ensuring good visibility around turns at night.

**02 Raised Roof Rails**

The side sill step makes it easy for anyone to use the roof rails. The built-in loopholes help secure your outdoor equipment with ropes for extra peace of mind.

**03 Panoramic Power Sunroof**

Take in the night sky or enjoy the outdoors from inside. A wide-open panoramic sunroof makes driving more enjoyable for all passengers.

**04 Harman Kardon Premium Audio System**

Harman Kardon's GreenEdge premium audio system includes 14 high-efficiency Harman Kardon speakers for powerful, deep bass and improved acoustics for a richer audio experience.

**05 2-position Memory Driver Seat**

The Evoltis welcomes you personally with a convenient 2-position memory driver's seat.

**06 USB Power Ports**

USB charging ports are available in every row so all passengers can charge their smartphones and tablets no matter where they sit.

**07 10-way Power and Cushion Length Adjuster Driver's Seat**

Adjust the length of the seat cushion to fit your body type. The driver's seat retains firmness and support, helping you maintain good driving posture.

**08 19 Cup and Bottle Holders**

A total of 19 cup and bottle holders are available inside the vehicle for everyone's convenience.

Disclaimer: The information and/or illustrations herein are for illustrative purposes only. Specifications of models may vary across markets and be dependent on local requirements and availability.



Abyss Blue Pearl

**EVOLTIS Touring EyeSight**

DIMENSIONS..... L x W x H: 4998 x 1930 x 1819 mm  
 ENGINE..... Horizontally opposed, 4-cylinder, 4-stroke, DOHC Turbocharged 16-valve, petrol  
 CAPACITY..... 2387 cc  
 MAX OUTPUT..... 194 kW (260 PS) / 5,600 rpm  
 MAX TORQUE..... 375 Nm (277 kgfm) / 2,000 - 4,800 rpm  
 TRANSMISSION..... Lineartronic, AWD

EXTERIOR COLOURS



Crystal White Pearl

Ice Silver Metallic

Crystal Black Silica

Abyss Blue Pearl

Crimson Red Pearl

Owing to printing locations, colours may differ slightly from those shown in this chart. In addition, colours and seat variations may vary according to the individual market.